

HW-V150

Auto , Manual Reset Circuit Breaker

SPECIFICATIONS

Single Pole Thermal Type Breakers

Rating : 5~50A ; 12 VDC ; 24VDC

Operating Temperature : -10°F(-23°C) to 150°F(65°C)

Storage Temperature : -20°F(-29°C) to 200°F(93°C)

Applications : Battery chargers, trucks, buses, RV's, trolling motors, etc.

The Test Complies with SAE Standard J553 (TYPE I III)



V150H-A 15A

V150-A-02 30A



V150-A-03 10A

V150-G 5A

CALIBRATION

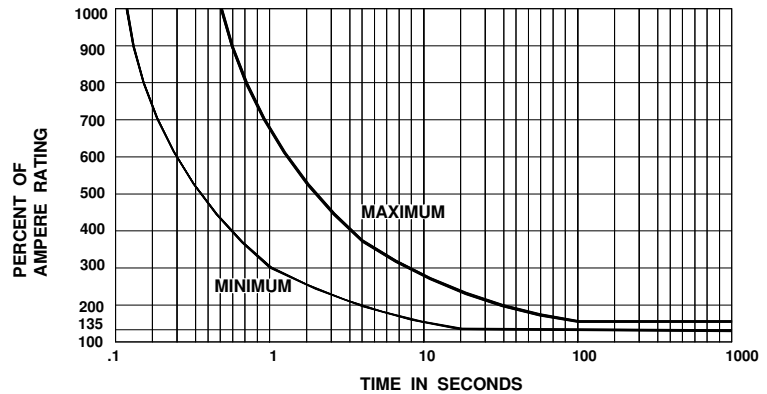

TERMINAL OPTION

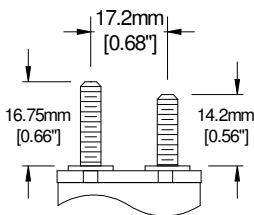

**TWO 10-32 STUDS;
.66 (AUX); .56 (BAT)**

A

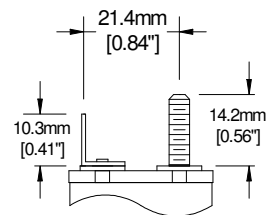

**ONE .25 Q.C. (AUX) ;
ONE 10-32 STUD (BAT)**

B

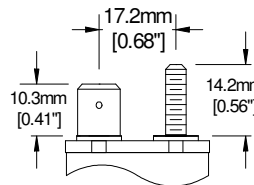

**DOUBLE .25 Q.C. (AUX) ;
ONE 10-32 STUD (BAT)**

C

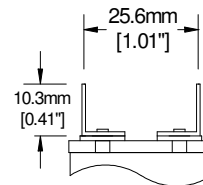

**TWO .25 Q.C.
(AUX & BAT)**

D

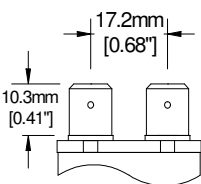

**TWO DOUBLE .25 Q.C.
(AUX & BAT)**

E

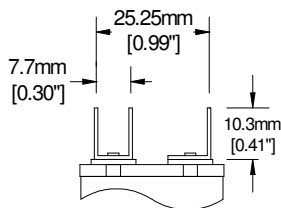

**DOUBLE .25 Q.C. (AUX) ;
SINGLE .25 Q.C. (BAT)**

F

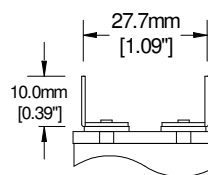

**TWO .187 Q.C.
(AUX & BAT)**

G

BRACKET OPTION

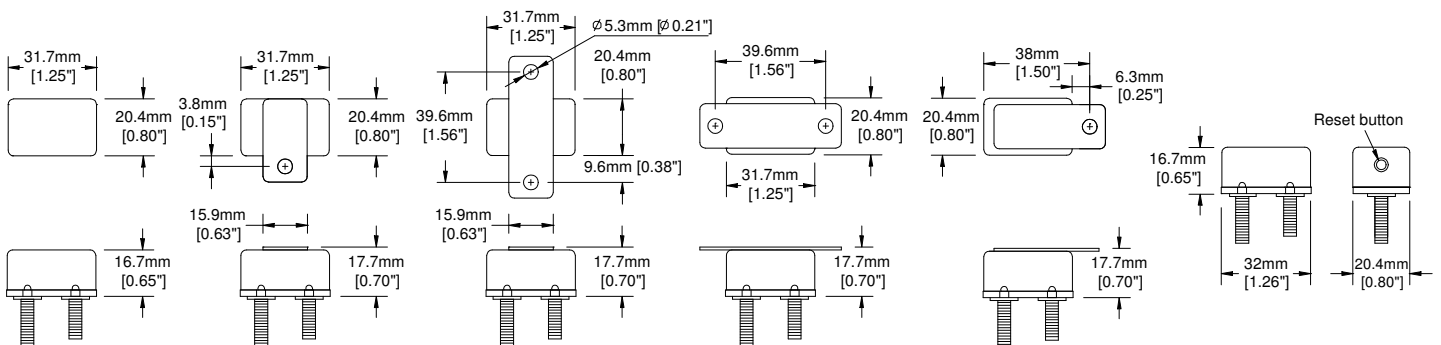

0 Bracket

01 Bracket

02 Bracket

03 Bracket

04 Bracket

**HW-V150H
0 Bracket**